





T7000 Series Thera-2080





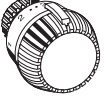
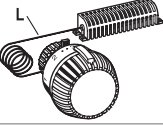



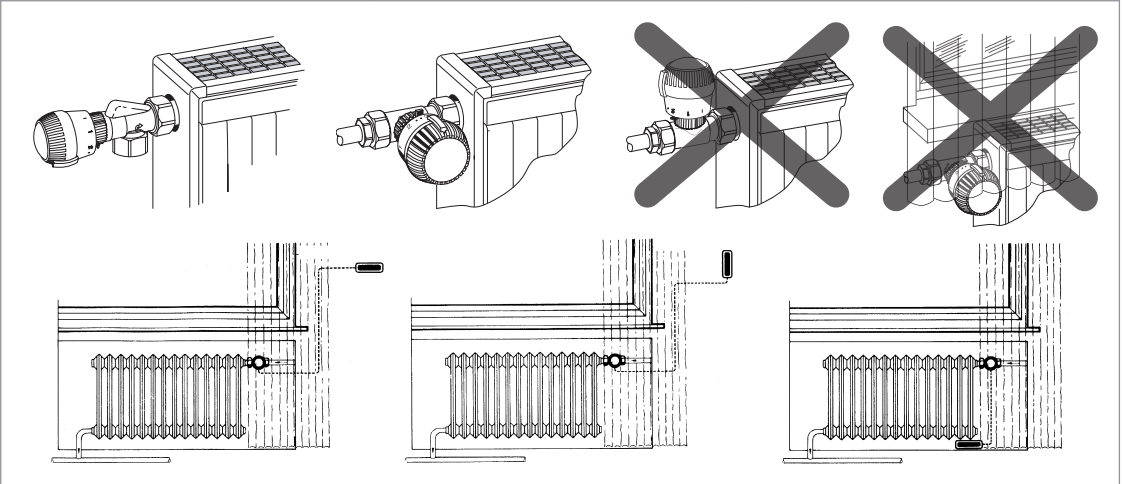
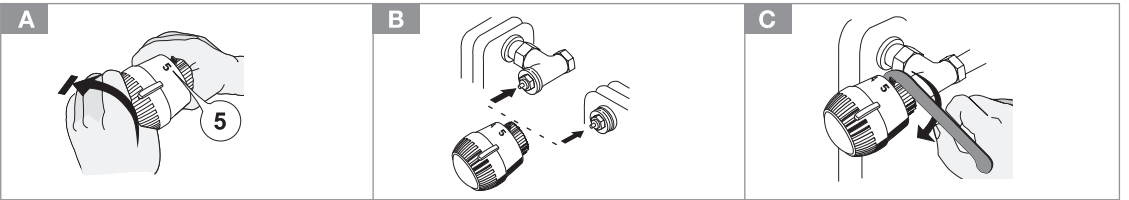

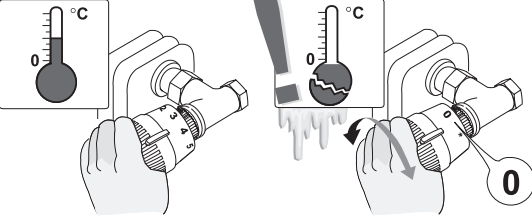



		 011	0 - * - 5	* - 5	* - 3		L
	T7001	•		•		M30x1,5	
	T7001B3	•			•	M30x1,5	
	T7001W0	•	•			M30x1,5	
	T700120	•		•		M30x1,5	2 m
	T700120W0	•	•			M30x1,5	2 m

	0	*	1	2	3	4	5
°C	1	6	11	16	21	25	28
°F	34	43	52	61	70	77	82

	*	1	2	3	4	5
°C	6	11	16	21	25	28
°F	43	52	61	70	77	82





	24°C	
	20°C	
	18-20°C	
	18°C	
	17-18°C	
	16-17°C	

T7000 SERIES THERA-2080



16° - 25°C

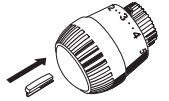
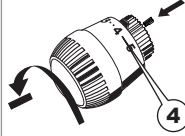
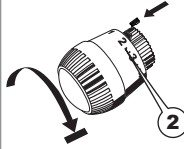
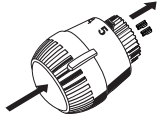
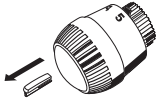

21°C

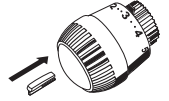
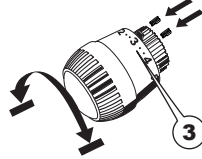
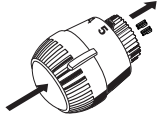
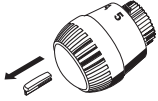
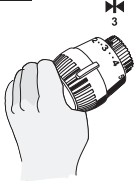

TA2080A001



TA1010HZ01

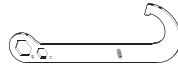

VA8210A001



TA1000A001
TA1000A002



TA1010DA01

For more information

homecomfort.resideo.com/europe



Ademco 1 GmbH
Hardhofweg 40
74821 MOSBACH
GERMANY
Phone: +49 6261 810
Fax: +49 6261 81309

Manufactured for and on behalf of the
Pittway Sàrl, La Pièce 4, 1180 Rolle, Switzerland
by its Authorised Representative Ademco 1 GmbH
MU2H-2004GE25 R1119
Subject to change
© 2019 Pittway Sàrl. All rights reserved.
This document contains proprietary information of
Pittway Sàrl and its affiliated companies and is
protected by copyright and other international
laws. Reproduction or improper use without specific
written authorisation of Pittway Sàrl is strictly
forbidden. The Honeywell Home trademark is used
under license from Honeywell International Inc.

Honeywell Home