



Centra Linear Valve ASV-PAC-4

- (D) Montageanweisung
- (F) Instruction de montage
- (I) Istruzioni per l'installazione
- (NL) Installatie instructies
- (DK) Installations vejledning
- (N) Montasjeveiledning
- (SF) Asennusohje
- (S) Installationsanvisning
- (E) Instrucciones de Instalación

INSTALLATION INSTRUCTIONS

**Packing for
Packung für
Bourrage de presse
étoupe pour
Anelli premistoppa per
Pakking voor
Pakning for**

**Tilviste venttiilille
Packning til
Prensaestopas para**

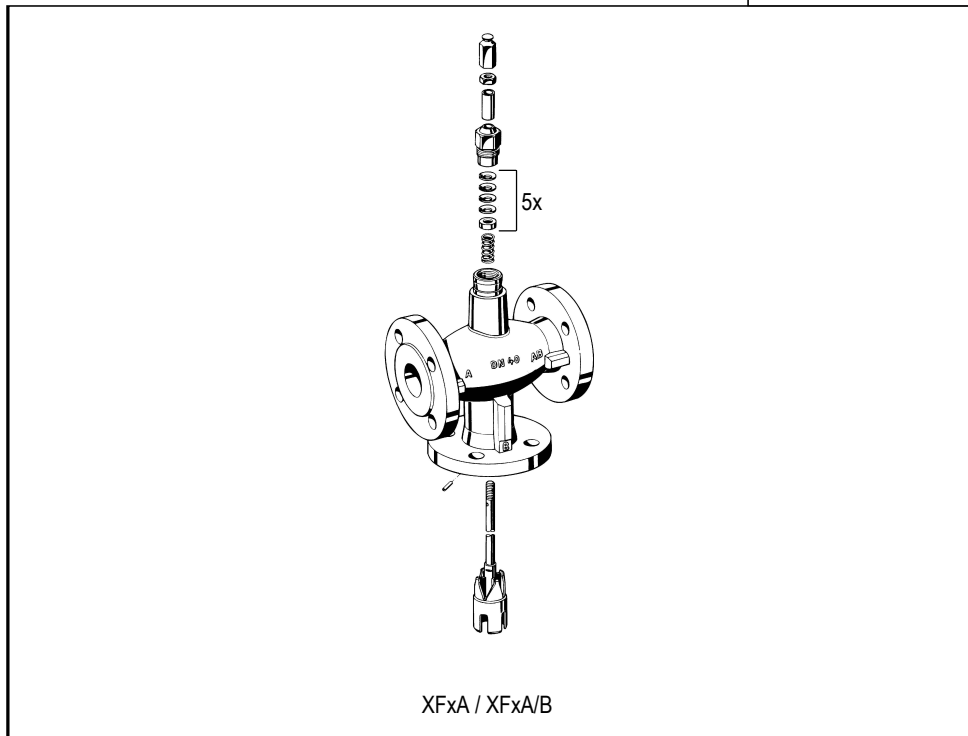
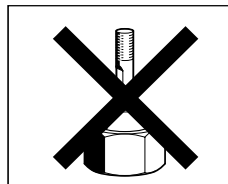
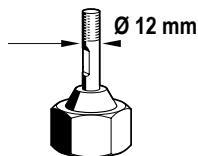

Assembly sequence
Reihenfolge des Zusammenbaus
Sequence de montage
Sequenza d'assemblaggio
Montagevolgorde
Montage-rækkefølge
Montasjerekkefølge
Kokoamisjärjestys
Hopsättning
Secuencia de montaje

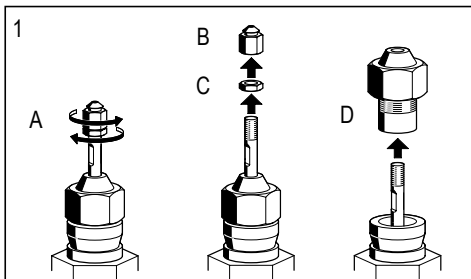
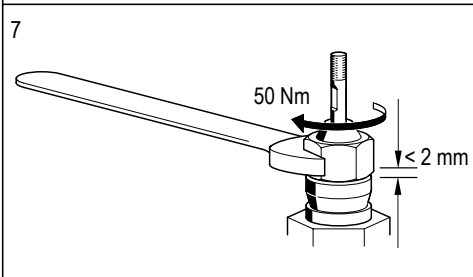
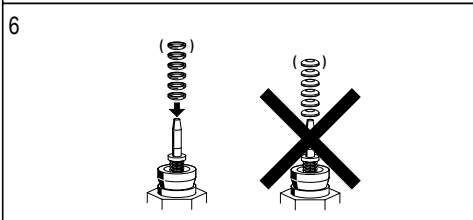
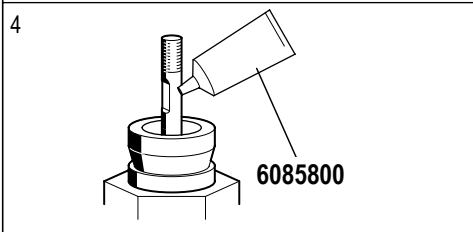
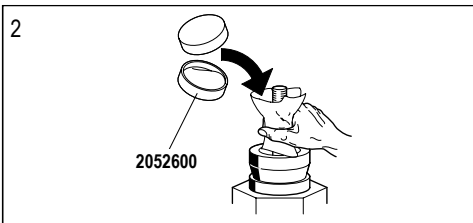

3 Thoroughly remove the grinding paste.
 Schleifpaste gründlich entfernen!
 Retirer soigneusement la pâte abrasive.
 Togliere completamente la pasta abrasiva.
 Slijppasta grondig verwijderen.
 Fjern slibepastaen grundigt.
 Slipepastaen fjernes grundigt.
 Poista hiomatahna perusteellisesti.
 Ta bort slippastan omsorgsfullt.
 Quitar la pasta de pulir esmeradamente.

5 Replacement tool Part-No. **0901735**
 Montagehilfe Best.-Nr.
 Kit d'aide de montage réf.
 Set di montaggio No. d'ord.
 Montagehulpset besteino.
 Montagehjælp-sæt best.-nr.
 Montasjehjelp-sett best.-nr.
 Asennusapusetti tilaus-nro.
 Monteringshjälpsats, artikelnummer
 Juego auxiliar de montaje No. de pedido

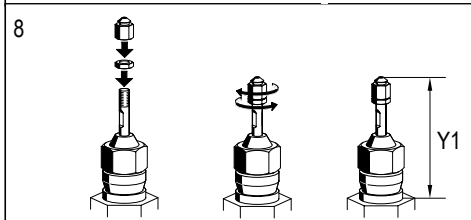

Valve	Y1 when the valve is closed
Ventil	Y1 bei geschlossenem Ventil
Soupape	Y1 avec la soupape fermée
Valvola	Y1 a valvola chiusa
Ventiel	Y1 bij gesloten ventiel
Ventil	Y1 ved lukket ventill
Ventil	Y1 ved lukket ventill
Venttiili	Y1 suljetussa venttiilissä
Ventil	Y1 vid stängd ventill
Válvula	Y1 con la válvula cerrada
XFxA	170,5 mm
XFxA/B	107 mm